

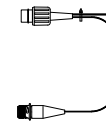

REGPOINT

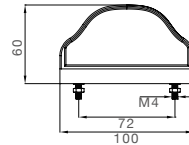

IP 54

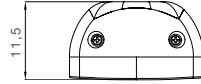

Kennzeichenlicht
Number plate light

BEST. NR				ZUSATZ	ANSCHLUSS	
PART NO				ADD ON	CONNECTOR	
36-3002-014	1/-		24V		offenes Ende open end	1,00 m
36-3003-014	1/-		24V		offenes Ende open end	0,30 m
36-3004-014	1/-		24V	M4x16	P&R	0,50 m
36-3004-024	1/-		24V		P&R	1,00 m
36-3004-034	1/-		24V		P&R	1,50 m
36-3004-044	1/-		24V		P&R	2,00 m
36-3004-054	1/-		24V		P&R	3,50 m
36-3007-284	1/-		24V		2 pol. ASS2 2 pin ASS2	0,55 m
36-3007-254	1/-		24V		2 pol. ASS2 2 pin ASS2	1,20 m
36-3007-084	1/-		24V		2 pol. ASS2 2 pin ASS2	3,50 m
36-3007-394	1/-		24V	M4x16	3 pol. ASS3 3 pin ASS3	0,50 m
36-3007-464	1/-		24V	M4x35	3 pol. ASS3 3 pin ASS3	0,50 m
36-3007-264	1/-		24V	[A]	2 pol. ASS2 2 pin ASS2 2 pol. ASS2 2 pin ASS2	1,02 m 0,2 m
36-3000-134	1/-		24V		2 pol. Superseal 2 pin Superseal	1,20 m
36-3007-574	1/-		24V		2 pol. ASS2 2 pin ASS2	0,70 m



REGPOINT

ZUBEHÖR / ACCESSORIES

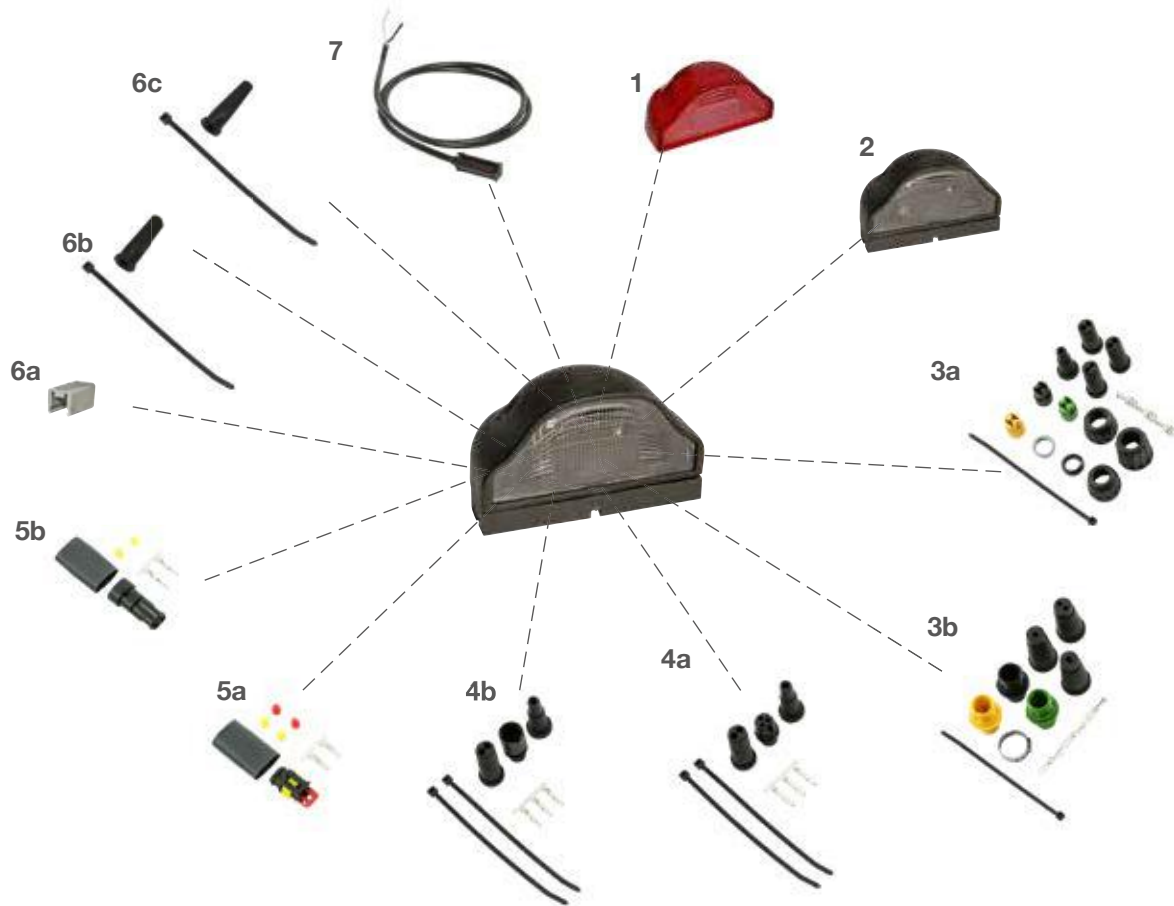

1 **Lichtscheibe | lens**
transparent rot
transparent red 18-8630-104

2 **Ersatzteilleuchte | spare part lamp**
weiß mit Schrauben
white with screws 26-3000-004

3 **ASS1 & ASS2 Verbinder | ASS1 & ASS2 connector**
(a) 2 pol. weiblich
2 pin female 13-5626-401
(b) 2 pol. männlich
2 pin male 13-5625-991

4 **ASS3 Verbinder | ASS3 connector**
(a) 3 pol. weiblich
3 pin female 13-0322-281
(b) 3 pol. männlich
3 pin male 13-0332-281

5 **Superseal Verbinder | Superseal connector**
(a) 2 pol. weiblich
2 pin female 15-7002-044
(b) 2 pol. männlich
2 pin male 15-7002-054

6 **für P&R Verbinder | for P&R connector**
(a) Verschlusskappen
caps 15-5971-014
(b) Endkappen rund
end caps round 15-5983-024
(c) Endkappen eckig
end caps square 15-5729-014

7 **Zuleitung P&R | front connection P&R**
0,5 m 68-5000-574
1,5 m 68-5000-604
2,0 m 68-5000-624
5,0 m 68-5000-634



REGPOINT rot
red



IP 54

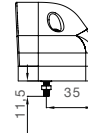
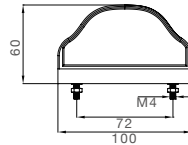
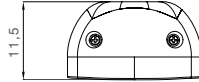

Kennzeichenlicht
Number plate light

BEST. NR				ZUSATZ ADD ON	ANSCHLUSS CONNECTOR
36-3004-184	1/-		24V		P&R 0,50 m
36-3004-084	1/-		24V		P&R 1,50 m



REGPOINT rot
red

ZUBEHÖR / ACCESSORIES

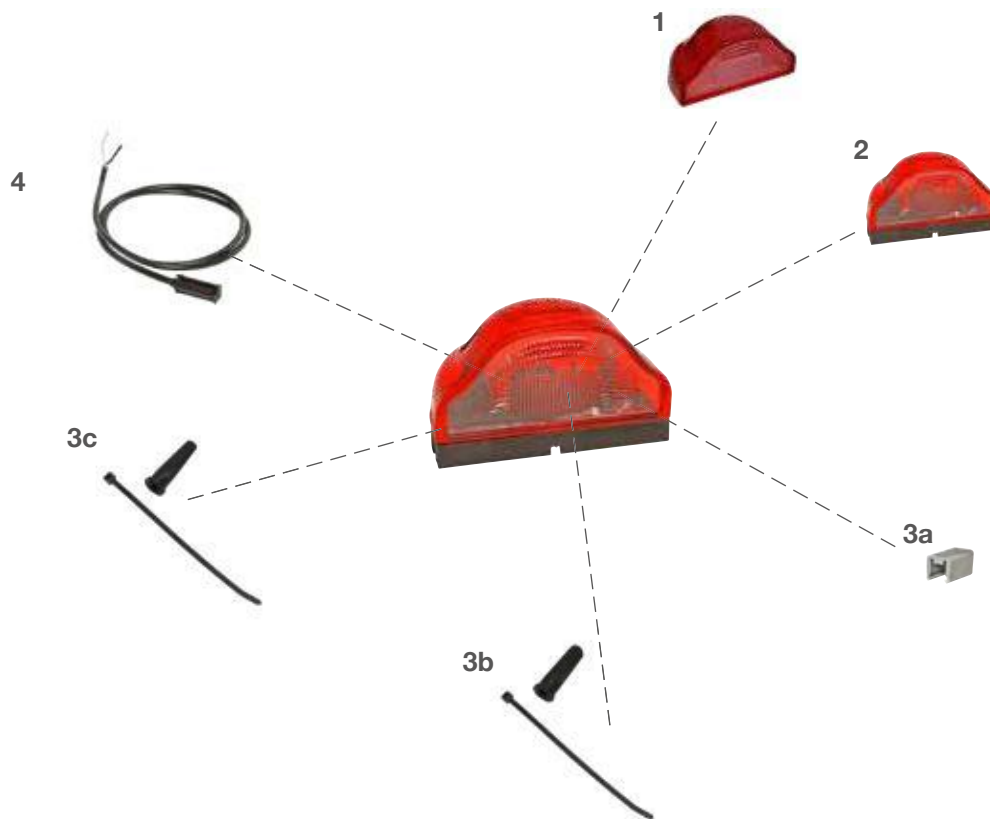

1 Lichtscheibe | lens
transparent rot
transparent red 18-8630-104

2 Ersatzteileuchte |
spare part lamp
rot mit Schrauben
red with screws..... 26-3010-004

3 für P&R Verbinder |
for P&R connector
(a) Verschlusskappen
caps..... 15-5971-014
(b) Endkappen rund
end caps round..... 15-5983-024
(c) Endkappen eckig
end caps square 15-5729-014







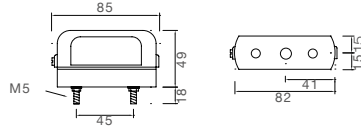



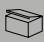

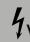

4 Zuleitung P&R | front connection P&R
0,5 m..... 68-5000-574
1,5 m..... 68-5000-604
2,0 m..... 68-5000-624
5,0 m..... 68-5000-634

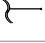

REGPOINT klein
small



 Kennzeichenlicht
Number plate light

BEST. NR				ZUSATZ ADD ON	ANSCHLUSS CONNECTOR
26-1200-004	1/-	-			Tülleneingang grommet  
36-1204-034	1/-		24V		P&R   0,50 m 
36-1207-004	1/-		24V		2 pol. ASS2 2 pin ASS2    1,50 m 



REGPOINT klein
small

ZUBEHÖR / ACCESSORIES

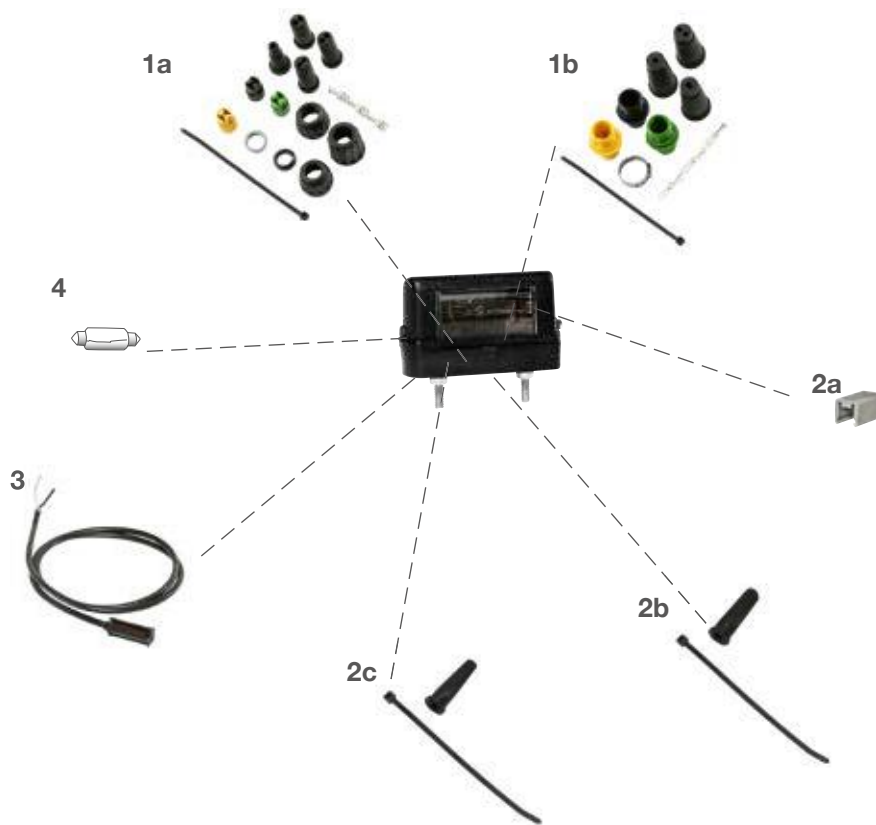

1 ASS1 & ASS2 Verbinder |
ASS1 & ASS2 connector

- (a) 2 pol. weiblich
2 pin female 13-5626-401
- (b) 2 pol. männlich
2 pin male 13-5625-991

2 für P&R Verbinder |
for P&R connector

- (a) Verschlusskappen
caps 15-5971-014
- (b) Endkappen rund
end caps round 15-5983-024
- (c) Endkappen eckig
end caps square 15-5729-014

3 Zuleitung P&R | front connection P&R
0,5 m 68-5000-574

4 Soffitte
24V 5W 16-6705-017