

Bayonet
15 pin

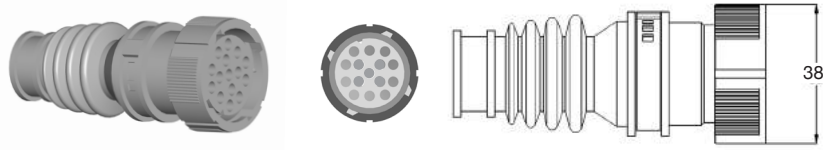

SPARE PART NO.: 13-1540-004

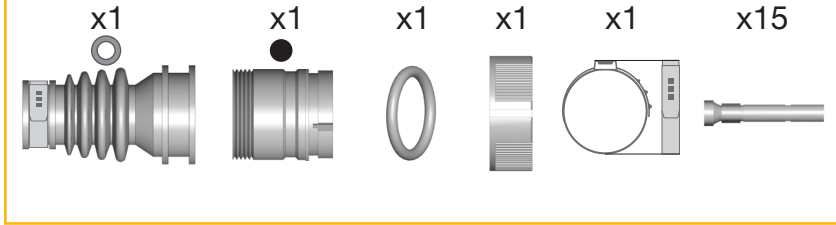

Bayonet
15 pin

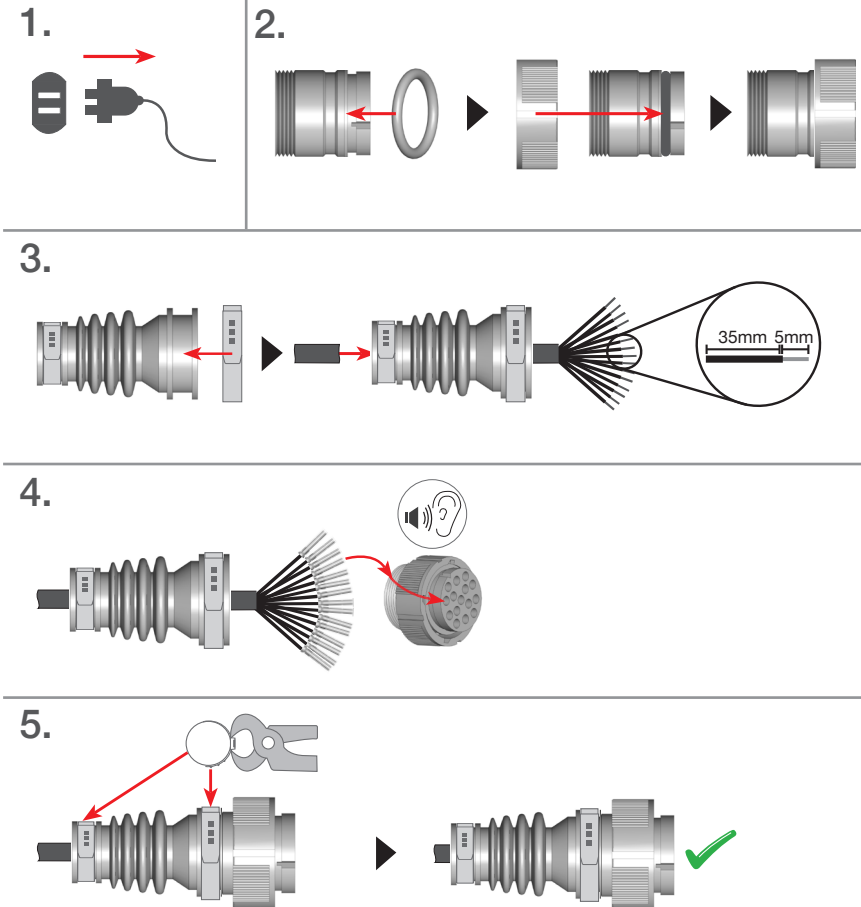
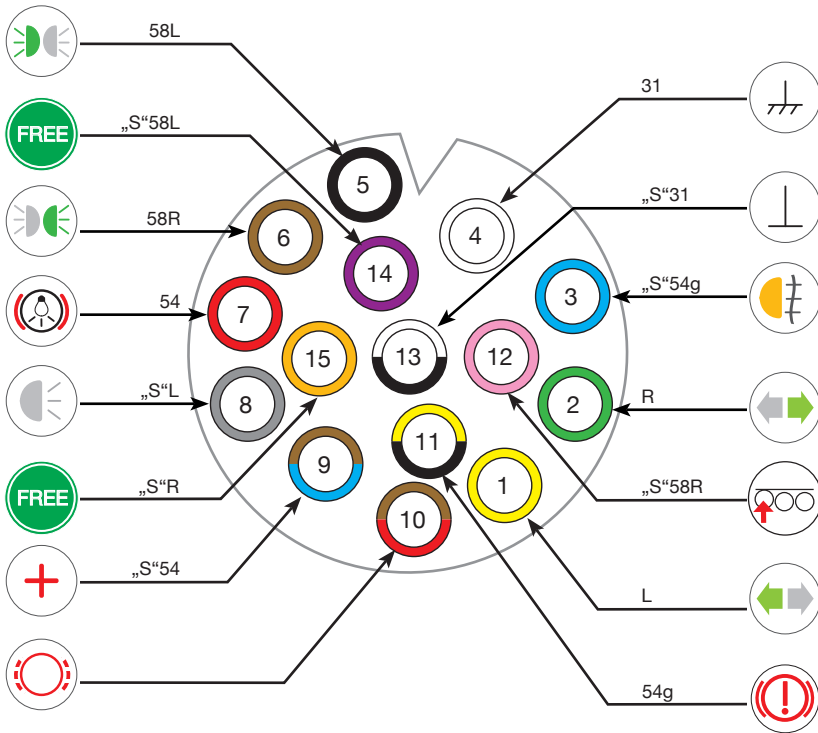

Imax=16A



Imax=16A



Bayonet 15 pin

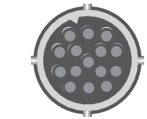
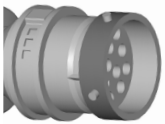

Imax=16A

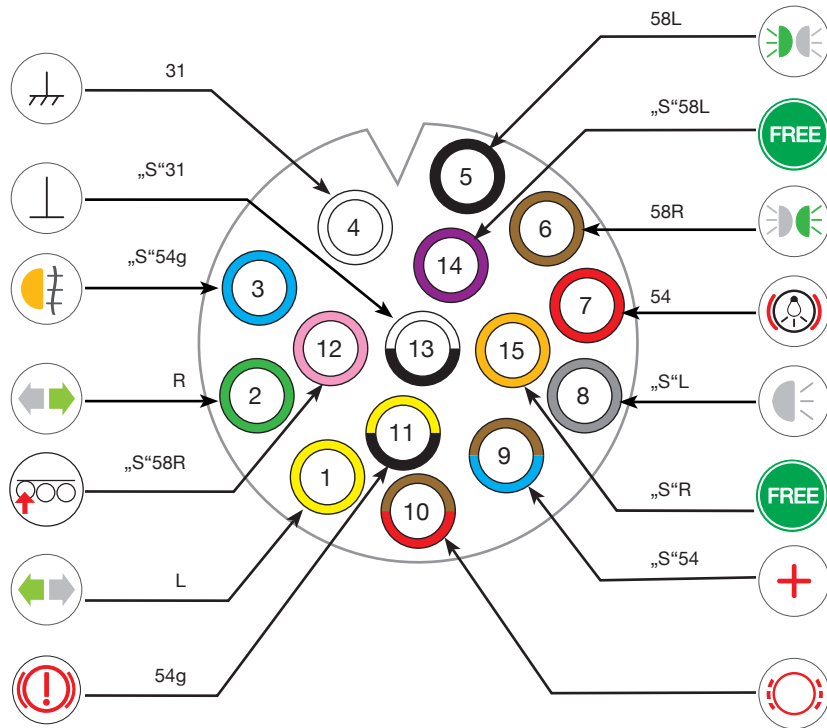
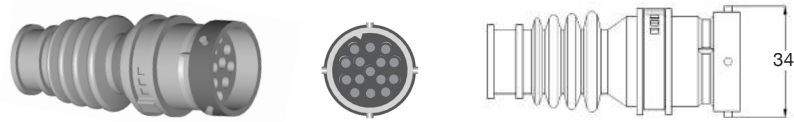

Bayonet 15 pin

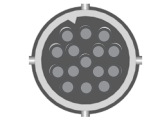
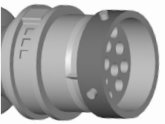

Imax=16A



SPARE PART NO.: 13-1530-004

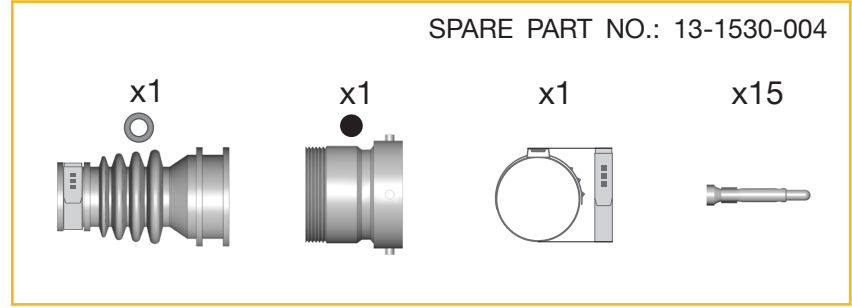

1. Plug the cable into the connector.
2. Push the connector onto the cable.
3. Push the connector onto the cable until the pins are fully inserted. A 35mm x 5mm dimension is shown for the cable length.
4. Push the connector onto the cable until the pins are fully inserted. A warning icon is shown.
5. Push the connector onto the cable until the pins are fully inserted. A warning icon is shown.