

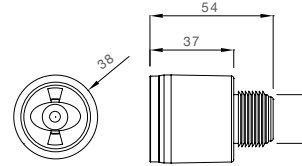

MONOPOINT II LED

ADR Zone 2 IP 6K9K

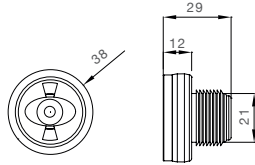

BEST. NR				ZUSATZ	ANSCHLUSS
PART NO				ADD ON	CONNECTOR
31-6700-024	1/-	LED	12V 24V		offenes Ende open end 3,50 m
31-6704-064	1/-	LED	12V 24V		P&R 0,50 m
31-6704-074	1/-	LED	12V 24V		P&R 1,50 m
31-6704-084	1/-	LED	12V 24V		P&R 3,50 m
31-6704-124	1/-	LED	12V 24V		P&R 5,00 m
31-6704-204	1/-	LED	12V 24V		P&R 1,70 m
31-6707-054	-/-	LED	12V 24V		3 pol. ASS3 ♀ 1,50 m
31-6700-044	1/-	LED	12V 24V		2 pol. MKR plus Lear ♀ 0,50 m
31-6700-064	-/-	LED	12V 24V		2 pol. Superseal ♀ 0,25 m
31-6700-014	1/-	LED	12V 24V	+ [A]	offenes Ende open end 3,70 m
31-6700-034	1/-	LED	12V 24V		offenes Ende open end 3,50 m
31-6704-094	1/-	LED	12V 24V		P&R 0,50 m
31-6704-104	1/-	LED	12V 24V		P&R 1,50 m
31-6704-114	1/-	LED	12V 24V		P&R 3,50 m



MONOPOINT II LED

ADR Zone 2 IP 6K9K

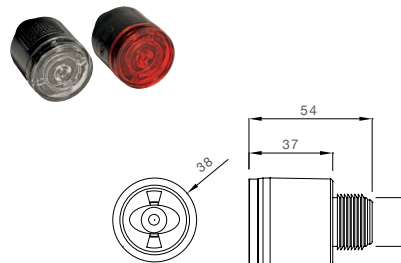
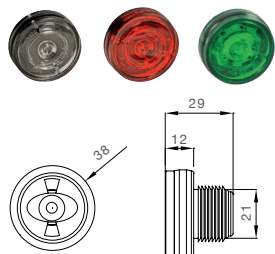

BEST. NR				ZUSATZ	ANSCHLUSS
PART NO				ADD ON	CONNECTOR
31-6800-014	1/-	LED	12V 24V		offenes Ende open end 3,50 m
31-6804-064	1/-	LED	12V 24V		P&R 3,50 m
31-6804-084	1/-	LED	12V 24V		P&R 0,50 m
31-6804-094	-/-	LED	12V 24V		P&R 5,00 m
31-6807-014	-/-	LED	12V 24V		3 pol. ASS3 3 pin ASS3 0,50 m
31-6804-074	1/-	LED	12V 24V		P&R 3,50 m
31-7400-004	-/-	LED	12V 24V		offenes Ende open end 3,50 m
31-7400-014	-/-	LED	12V 24V		offenes Ende open end 1,00 m



MONOPOINT II LED

ZUBEHÖR / ACCESSORIES

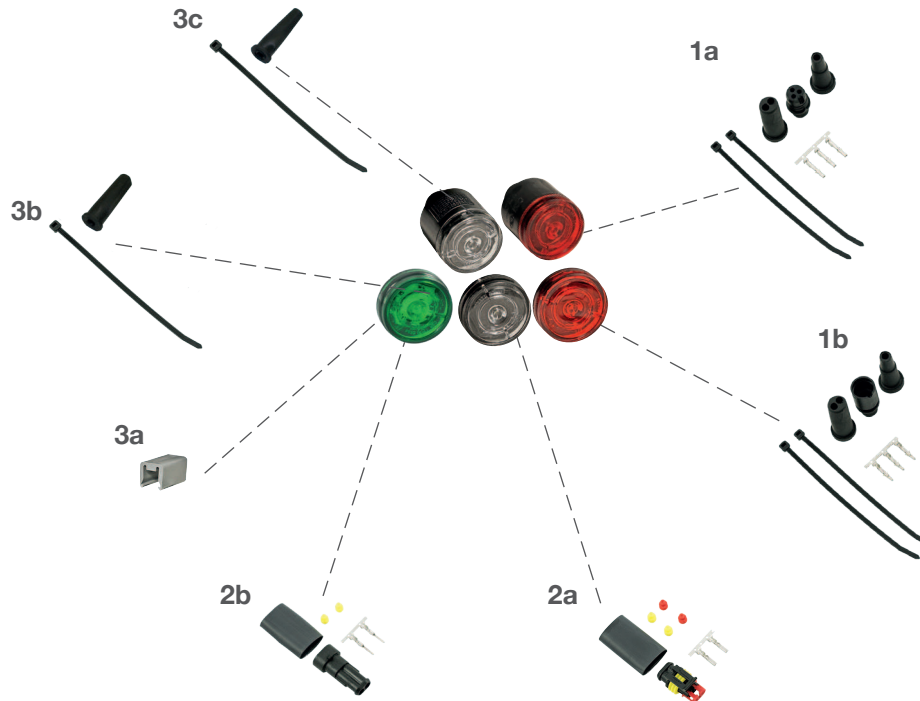

1 ASS3 Verbinder | ASS3 connector

- (a) 3 pol. weiblich
3 pin female 13-0322-281
- (b) 3 pol. männlich
3 pin male 13-0332-281

2 Superseal Verbinder | Superseal connector

- (a) 2 pol. weiblich
2 pin female 15-7002-044
- (b) 2 pol. männlich
2 pin male 15-7002-054

3 für P&R Verbinder | for P&R connector

- (a) Verschlusskappen
caps 15-5971-014
- (b) Endkappen rund
end caps round 15-5983-024
- (c) Endkappen eckig
end caps square 15-5729-014